

## TWT HYDRAULIC CYLINDERS

TWT cylinders operate with a maximum pressure of 700Bar. With single and Double acting ranges TWT cylinders show Versatility in operational requirements and fulfill the needs of the user.

All single Acting Cylinders are spring return and Double Acting Cylinders are oil return.



Capacity: 13-95 ton  
Stroke: 42-155 mm  
Max. Pressure: 700 bar



### TWT SINGLE-ACTING HOLLOW HYDRAULIC CYLINDER

Cylinder Capacity	Stroke	Model Number	Oil Capacity	Collapsed Height	Extend Height	Outside Dia.	Cylinder Bore Dia.	Plunger Dia. (Thread)	Weight
				A	B			C	
ton (kN)	(mm)		(cm)	(mm)	(mm)	(mm)	(mm)	(mm)	(Kg)
13 (125)	42	UHCL 130-42	76	130	172	76	55	35.5	3.4
	76	UHCL 130-76	138	184	260	76	55	35.5	5.2
20 (215)	49	UHCL 200-49	174	162	211	101	77	54.5	8.2
	155	UHCL 200-155	550	306	461	101	77	54.5	15
30 (326)	64	UHCL 300-64	307	180	244	115	90	64.5	11.5
	155	UHCL 300-155	744	330	485	115	90	64.5	21.5
60 (576)	76	UHCL 600-76	640	247	323	159	125	94.5	28.2
	153	UHCL 600-153	1278	323	476	159	125	94.5	35.5
95 (931)	76	UHCL 1000-76	1028	254	330	212	165	125	63.5

# SINGLE ACTING HYDRAULIC CYLINDER

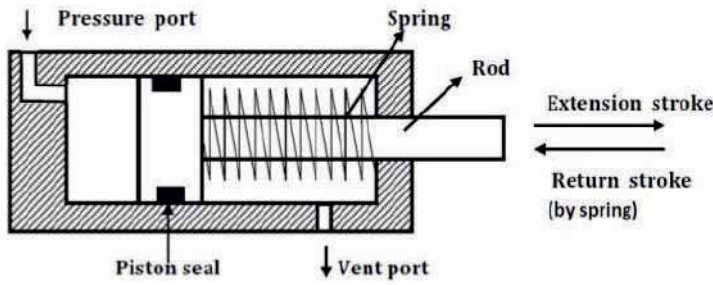

Capacity: 5-95 ton  
 Stroke: 25-362 mm  
 Max. Pressure: 700 bar

Cylinder Capacity ton	Stroke (mm)	Model Number	Oil Capacity	Collapsed Height	Extended Height	Outside Dia.	Cylinder Bore Dia.	Plunger Dia.	Weight (Kg)
			(cm <sup>3</sup> )	A (mm)	B (mm)	C (mm)	D (mm)	E (mm)	
5 (45)	25	UCL 5-25	18	110	135	40	30	25	1
	76	UCL 5-76	54	165	241	40	30	25	1.6
	127	UCL 5-127	90	215	342	40	30	25	2
	177	UCL 5-177	125	273	450	40	30	25	2.6
	232	UCL 5-232	164	323	555	40	30	25	3.1
10 (101)	54	UCL 10-54	86	121	175	59	45	35	2.3
	105	UCL 10-105	167	171	276	59	45	35	3
	156	UCL 10-156	248	247	403	59	45	35	4.1
	203	UCL 10-203	323	298	501	59	45	35	5.8
	257	UCL 10-257	409	349	606	59	45	35	6.6
	304	UCL 10-304	483	400	707	59	45	35	7.5
15 (142)	356	UCL 10-356	566	450	806	59	45	35	8.3
	25	UCL 15-25	53	124	149	70	52	42	3.5
	51	UCL 15-51	108	149	200	70	52	42	4
	101	UCL 15-101	214	200	301	70	52	42	5
	152	UCL 15-152	323	271	423	70	52	42	7
	203	UCL 15-203	431	322	525	70	52	42	8
	254	UCL 15-254	539	373	627	70	52	42	9
25 (232)	305	UCL 15-305	647	423	728	70	52	42	10
	356	UCL 15-356	756	474	830	70	52	42	11
	26	UCL 25-26	86	139	165	85	65	56	6
	50	UCL 25-50	166	165	215	85	65	56	7
	102	UCL 25-102	338	215	317	85	65	56	8
	158	UCL 25-158	524	273	431	85	65	56	10
	210	UCL 25-210	696	323	533	85	65	56	12
30 (295)	261	UCL 25-261	866	374	635	85	65	56	14
	311	UCL 25-311	1031	425	736	85	65	56	15
	362	UCL 25-362	1201	476	838	85	65	56	17
	50	UCL 30-50	209	228	278	101	73	60	13
	100	UCL 30-100	418	278	378	101	73	60	16
50 (498)	209	UCL 30-209	874	387	596	101	73	60	19
	300	UCL 30-300	1255	478	778	101	73	60	27
	51	UCL 50-51	361	176	206	127	95	80	19
	101	UCL 50-101	716	227	307	127	95	80	19
75 (718)	159	UCL 50-159	1126	282	422	127	95	80	23
	337	UCL 50-337	2388	460	797	127	95	80	37
	156	UCL 75-156	1620	285	441	150	115	100	33
95 (933)	333	UCL 75-333	3457	492	825	150	115	100	54
	168	UCL 100-168	2229	357	525	177	130	112	59
	260	UCL 100-260	3449	449	709	177	130	112	72

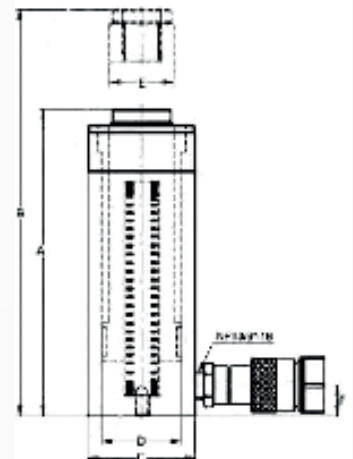
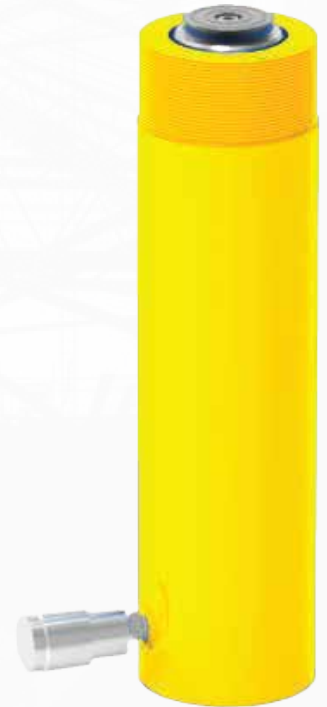

## SINGLE ACTING LOW PROFILE LOCK-NUT HYDRAULIC CYLINDER

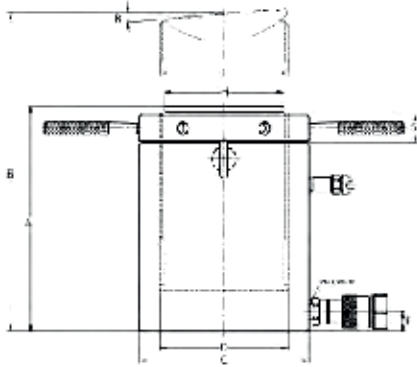

Capacity: 60-520 ton  
Stroke: 45-50 mm  
Max. Pressure: 700 bar



Cylinder Capacity ton	Stroke (mm)	Model Number	Oil Capacity	Collapsed Height	Extended Height	Outside Dia.	Cylinder Bore Dia.	Plunger Dia. (Thread)	Base to Advance port	Saddle Dia.	Saddle Protrusion from Plgr.	Saddle Max. Tilt Angle	Plunger Dia.	Weight (Kg)
				A (mm)	B (mm)	C (mm)	D (mm)	E (mm)	F (mm)	H (mm)	J (mm)	R (mm)	S (mm)	
60 (606)	50	UCLP 60-50	432	125	175	140	106	Tr104x4	19	96	6	5	28	15
100 (1027)	50	UCLP 100-50	734	137	187	180	137	Tr136x6	21	126	8	5	31	27
160 (1619)	45	UCLP 160-45	1040	148	193	224	172	Tr171x6	27	160	9	5	40	45.5
200 (1999)	45	UCLP 200-45	1285	155	200	245	190.7	Tr190x6	30	180	10	5	43	57
260 (2567)	45	UCLP 250-45	1650	159	204	275	216	Tr215x6	32	200	11	5	44	74
400 (3916)	45	UCLP 400-45	2517	178	223	350	270	Tr266x6	41	251	11	4	55	134
520 (5114)	45	UCLP 500-45	3287	192	237	400	305	Tr304x6	48	289	10	3	62	188



## SINGLE ACTING LOW PROFILE HYDRAULIC CYLINDER

Capacity: 10-150 ton  
Stroke: 11-80 mm  
Max. Pressure: 700 bar

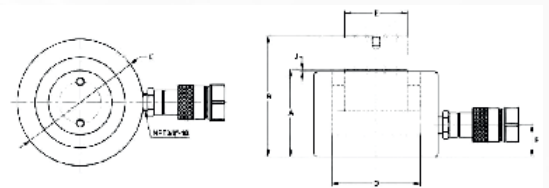

Cylinder Capacity ton (kN)	Stroke (mm)	Model Number	Oil Capacity (cm) <sup>3</sup>	Collapsed Height	Extend Height	Outside Dia.	Cylinder Bore Dia.	Plunger Dia. (Thread)	Base to Advance port	Saddle Protrusion from Plgr.	Saddle Max. Tilt Angle	Plunger to Mounting Hole	Weight (Kg)
				A (mm)	B (mm)	C (mm)	D (mm)	E (mm)	F (mm)	J (mm)	M (mm)	N (°)	
10 (101)	38	ULH 10-38	60	88	126	78	45	35	23	2	-	-	4
20 (201)	45	ULH 20-45	140	97	142	96	63	50	23	2	-	-	6.9
30 (295)	64	ULH 30-64	290	117	181	109	76	60	23	2	-	-	9.8
50 (435)	60	ULH 50-60	471	120	180	233	200	80	24	2	-	-	13.3
75 (718)	50	ULH 75-50	584	116	166	157	122	100	21	2	-	-	19
100 (887)	57	ULH 100-57	877	141	198	176	140	112	31	2	-	-	24.5
150 (1386)	51	ULH 150-51	1184	141	192	215	172	145	28	2	-	-	42
150 (1386)	80	ULH 150-80	1860	170	250	215	172	145	28	2	-	-	50

## SINGLE ACTING LOW FLAT HYDRAULIC CYLINDER

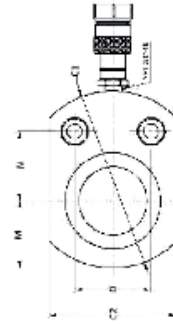
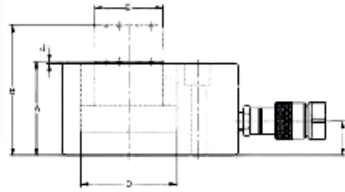

Capacity: 10-150 ton  
Stroke: 11-80 mm  
Max. Pressure: 700 bar

Cylinder Capacity ton (kN)	Stroke (mm)	Model Number	Oil Capacity (cm <sup>3</sup> )	Collapsed Height	Extend Height	Outside Dia.	Cylinder Bore Dia.	Plunger Dia. (Thread)	Base to Advance port	Saddle Protrusion from Plgr.	Saddle Max. Tilt Angle	Plunger to Mounting Hole	Weight (Kg)
				A	B	C	D	E	F	J	M	N	
10 (101)	11	ULFH 10-11	18	44	55	83x60	45	35	23	1	31.5	34	1.4
20 (201)	12	ULFH 20-12	37	52	64	102x80	63	50	23	1	41	39	2.2
30 (295)	13	ULFH 30-13	59	58	71	117x97	76	60	23	1	48.5	47	4.2
50 (435)	16	ULFH 50-16	125	67	83	150x125	100	80	23	1	63	60	7.4
75 (718)	16	ULFH 75-16	187	79	96	177x152	122	100	23	1	76.5	73	12.7
100 (887)	16	ULFH 100-16	246	87	103	203x179	140	112	23	1	89.5	84	15.5
150 (1386)	16	ULFH 150-16	371	95	111	236x212	172	145	23	1	106	92	28.7

## DOUBLE ACTING HOLLOW HYDRAULIC CYLINDER

Capacity: 30-145 ton  
Stroke: 38-258 mm  
Max. Pressure: 700 bar

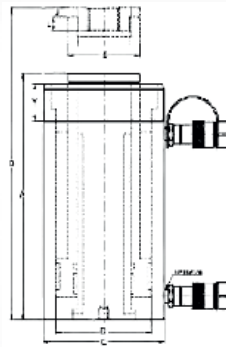

Cylinder Capacity ton (kN)	Stroke (mm)	Model Number	Max. Cylinder Capacity		Oil Capacity		Collapsed Height	Extend Height	Outside Dia.	Cylinder Bore Dia.	Plunger Dia. (Thread)	Weight (Kg)
			Advance	Retract	Advance	Retract	A	B	C	D	E	
			(kN)		(cm <sup>3</sup> )		(mm)	(mm)	(mm)	(mm)	(mm)	(Kg)
30	178	THH 300-178	326	210	855	550	330	508	115	90	64.5	21
	258	THH 300-258	326	210	1240	798	431	689	115	90	64.5	27
60	89	THH 600-89	576	360	749	468	247	336	159	125	94.5	28
	166	THH 600-166	576	360	1398	873	323	489	159	125	94.5	35
	257	THH 600-257	576	360	2146	1352	438	695	159	125	94.5	45
95	38	THH 1000-38	931	627	517	345	165	203	212	165	125	33
	76	THH 1000-76	931	627	1028	692	254	330	212	165	125	61
	153	THH 1000-153	931	627	2070	1394	342	495	212	165	125	79
	257	THH 1000-257	931	627	3477	2341	460	717	212	165	125	106
145	203	THH 1500-203	1429	749	4191	2198	359	562	247	190.5	150	111

# DOUBLE ACTING HIGH TONNAGE HYDRAULIC CYLINDER

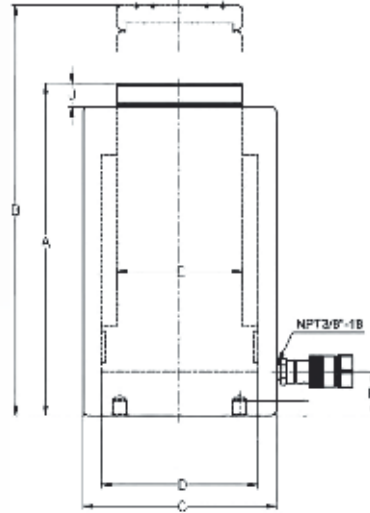
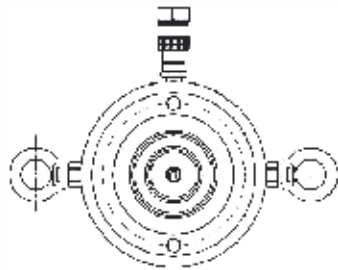

Cylinder Capacity	Stroke	Model Number	Cylinder Effective Area	Oil Capacity	Collapsed Height	Extend Height	Outside Dia.	Cylinder Bore Dia.	Plunger Dia.	Base to Advance Port	Weight
					A	B	C	D	E	F	
ton	(mm)		(cm <sup>2</sup> )	(cm <sup>3</sup> )	(mm)	(mm)	(mm)	(mm)	(mm)	(mm)	(Kg)
50	50	UTH 50-50	78.5	392	188	238	140	100	70	41	21.5
	100	UTH50-100	78.5	784	238	338	140	100	70	41	26
	150	UTH50-150	78.5	1176	288	438	140	100	70	41	31
	200	UTH50-200	78.5	1568	338	538	140	100	70	41	35
	300	UTH50-300	78.5	2352	438	738	140	100	70	41	44
100	50	UTH100-50	153.9	770	216	266	180	140	100	54	42
	100	UTH100-100	153.9	1540	266	366	180	140	100	54	49
	150	UTH 100-150	153.9	2310	316	466	180	140	100	54	56
	200	UTH100-200	153.9	3080	366	566	180	140	100	54	63
	300	UTH100-300	153.9	4620	466	766	180	140	100	54	70
150	50	UTH 150-50	201	1005	224	274	210	160	112	58	44
	100	UTH150-100	201	2010	274	374	210	160	112	58	57
	150	UTH150-150	201	3015	324	474	210	160	112	58	70
	200	UTH150-200	201	4020	374	574	210	160	112	58	83
	300	UTH 150-300	201	6030	474	774	210	160	112	58	109
200	50	UTH200-50	314	1570	246	296	250	200	150	64	84
	150	UTH 200-150	314	4712	346	496	250	200	150	64	118
	300	UTH 200-300	314	9423	496	796	250	200	150	64	152
320	50	UTH 300-50	490.6	2453	277	327	315	250	180	74	155
	150	UTH 300-150	490.6	7359	377	527	315	250	180	74	195
	300	UTH 300-300	490.6	14718	527	827	315	250	180	74	255
400	50	UTH400-50	572.3	2861	305	355	355	270	220	83	240
	150	UTH400-150	572.3	8583	405	555	355	270	220	83	310
	300	UTH400-300	572.3	17169	555	855	355	270	220	83	415
500	50	UTH500-50	803.8	4019	325	375	395	320	250	93	285
	150	UTH 500-150	803.8	12057	425	575	395	320	250	93	353
	300	UTH500-300	803.8	24114	575	875	395	320	250	93	455
630	50	UTH 600-50	1017.4	5087	386	436	450	360	280	115	487
	150	UTH 600-150	1017.4	15261	486	636	450	360	280	115	579
	300	UTH600-300	1017.4	30522	636	936	450	360	280	115	717
800	50	UTH 800-50	1256	6280	427	477	550	400	320	113	712
	150	UTH 800-150	1256	18840	527	677	550	400	320	113	860
	300	UTH800-300	1256	37698	677	977	550	400	320	113	1082



# DOUBLE ACTING HIGH TONNAGE HYDRAULIC CYLINDER

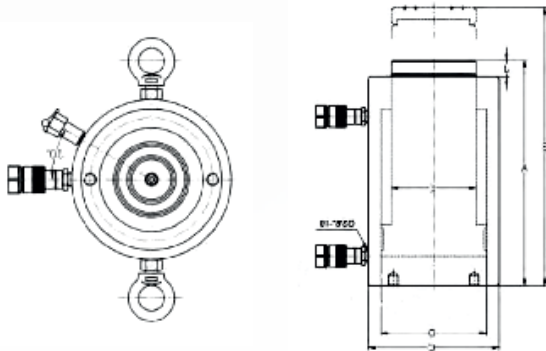

Capacity: 50-800 ton  
Stroke: 50-300 mm  
Max. Pressure: 700 bar



Cylinder Capacity	Stroke	Model Number	Max. Cylinder Capacity		Oil Capacity		Collapsed Height	Extended Height	Outside Dia.	Cylinder Bore Dia.	Plunger Dia.	Weight
			Advance	Retract	Advance	Retract	A	B	C	D	E	
ton	(mm)		(KN)		(cm <sup>3</sup> )		(mm)	(mm)	(mm)	(mm)	(mm)	(Kg)
50	50	THT50-50	500	255	392	200	188	238	140	100	70	21.5
	100	THT50-100	500	255	784	400	238	338	140	100	70	26
	150	THT50-150	500	255	1176	600	288	438	140	100	70	31
	200	THT50-200	500	255	1563	800	338	538	140	100	70	35
	300	THT50-300	500	255	2352	1200	438	738	140	100	70	44
100	50	THT100-50	1000	490	770	377	216	266	180	140	100	42
	100	THT100-100	1000	490	1540	754	266	366	180	140	100	49
	150	THT100-150	1000	490	2310	1131	316	466	180	140	100	56
	200	THT100-200	1000	490	3080	1508	366	566	180	140	100	63
	300	THT100-300	1000	490	4620	2262	466	766	180	140	100	70
150	50	THT150-50	1390	709	1005	512	224	274	210	160	112	44
	100	THT150-100	1390	709	2010	1025	274	374	210	160	112	57
	150	THT150-150	1390	709	3015	1537	324	474	210	160	112	70
	200	THT150-200	1390	709	4020	2050	374	574	210	160	112	83
	300	THT150-300	1390	709	6030	3075	474	774	210	160	112	109
200	100	THT200-100	2000	875	3141	1374	296	396	250	200	150	109
	150	THT200-150	2000	875	4712	2061	346	496	250	200	150	121
	200	THT200-200	2000	875	6282	2748	396	596	250	200	150	132
	300	THT200-300	2000	875	9423	4122	496	796	250	200	150	155
300	100	THT300-100	3193	1537	4906	2363	327	427	315	250	180	180
	200	THT300-200	3193	1537	9812	4726	427	627	315	250	180	220
	300	THT300-300	3193	1537	14718	7089	527	827	315	250	180	260
400	100	THT400-100	3919	1317	5723	1924	355	455	355	270	220	255
	200	THT400-200	3919	1317	11446	3848	455	655	355	270	220	310
	300	THT400-300	3919	1317	17169	5772	555	855	355	270	220	375
500	100	THT500-100	5000	1948	8038	3133	375	475	395	320	250	326
	200	THT500-200	5000	1948	16076	6266	475	675	395	320	250	394
	300	THT500-300	5000	1948	24114	9399	575	875	395	320	250	462
600	100	THT600-100	6300	2488	10174	4019	436	536	450	360	280	542
	200	THT600-200	6300	2488	20348	8038	536	736	450	360	280	634
	300	THT600-300	6300	2488	30522	12057	636	936	450	360	280	726
800	100	THT800-100	8000	2880	12566	4522	477	577	550	400	320	796
	200	THT800-200	8000	2880	25132	9044	577	777	550	400	320	944
	300	THT800-300	8000	2880	37698	13566	677	977	550	400	320	1092